

MEIGSVILLE TOWNSHIP SECTION 17 R11 TWP 10 MORGAN COUNTY, OHIO

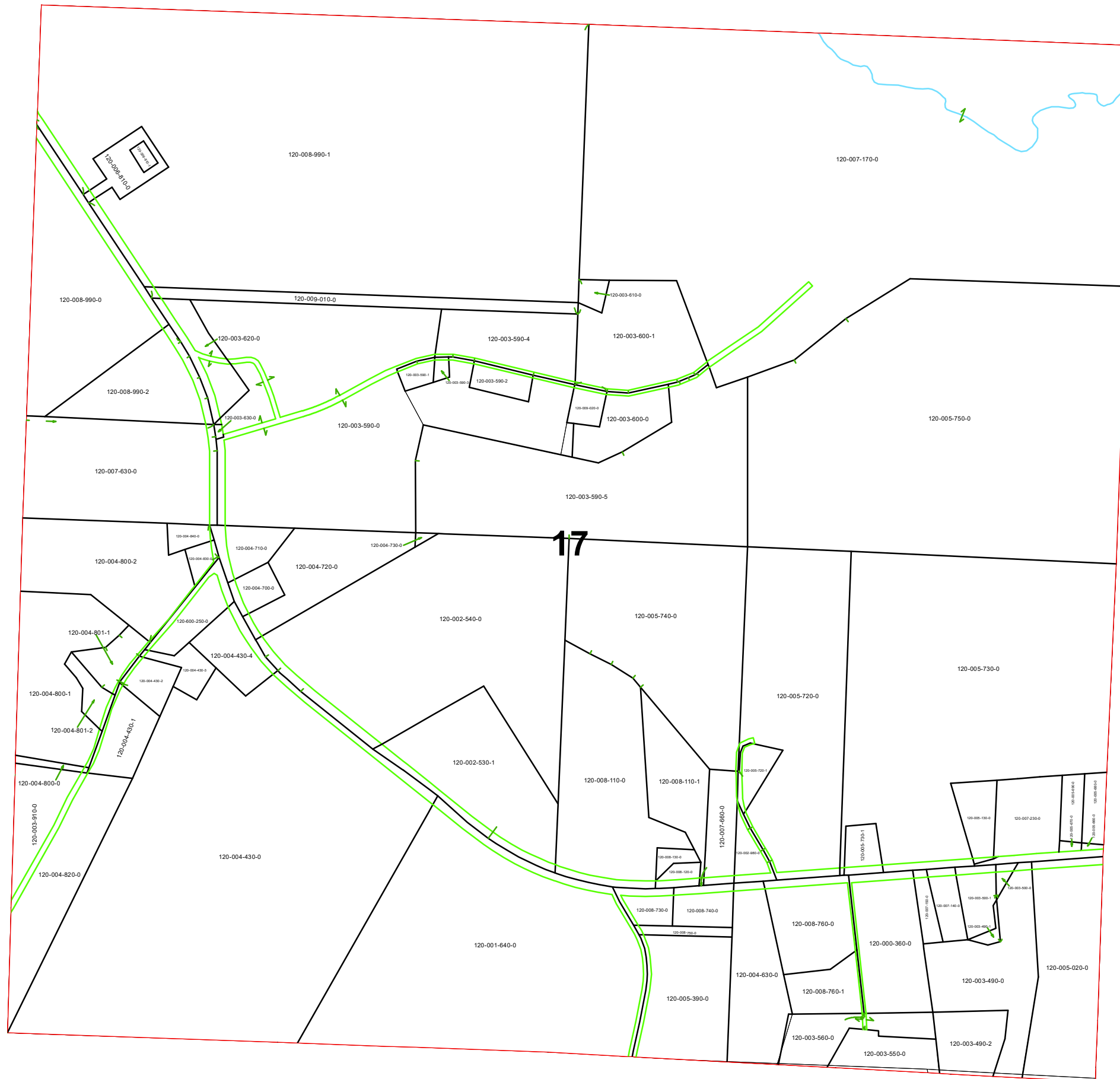

PIN	Owner	VOL	PAG	LegalDescr	Acres	Survey_Ref
120-004-801-1	BAKER CHANDLER D	OR232	3914	R11 T10 S17 SD 95	1.453	MIG-0420.pdf
120-003-550-0	BURKHART JEREMY & ANGELA	OR234	1851	R11 T10 S17 SD 43	4.878	MIG-0497.pdf
120-009-010-0	CAIN GERALD DEAN & THERESA	OR174	85	R11 T10 S17 SD 26	2.96	NoSurvey.pdf
120-008-990-0	CAIN GERALD DEAN & THERESA	OR174	85	R11 T10 S17 SD 21	13.011	MIG-0361.pdf
120-008-990-1	CAIN GERALD DEAN & THERESA	OR174	85	R11 T10 S17 SD 88	85.831	MIG-0361.pdf
120-005-730-0	CHEW LINDELL A & LOIS MARLENE TRUS	OR191	434	R11 T10 S17 SD 10	33	MIG-0329.pdf
120-005-720-0	CHEW LINDELL A & LOIS MARLENE TRUS	OR191	434	R11 T10 S17 SD 7	27.898	MIG-0329.pdf
120-005-740-0	CHEW LINDELL A & LOIS MARLENE TRUS	OR191	434	R11 T10 S17 SD 24	16.68	MIG-0329.pdf
120-005-750-0	CHEW LINDELL A & LOIS MARLENE TRUS	OR191	434	R11 T10 S17 SD 6	56.25	MIG-0329.pdf
120-001-640-0	CHILDS PHILLIP C & TERI LYNN TOD COL	OR232	2747	R11 T10 S17 SD 36	35.1	MIG-0490.pdf
120-004-430-1	COZZENS KENNETH & VICKI L	D.V 195	669	R11 T10 S17 SD 76	2.358	MIG-0137.pdf
120-007-230-0	ELLIS BRYCE W	OR228	2783	R11 T10 S17 SD 38	3.036	MIG-0476.pdf
120-005-720-1	GARNER KAREN J	OR152	23	R11 T10 S17 SD 86	1.056	MIG-0339.pdf
120-003-590-2	GERMAN DANIEL M & CHERI LEA WILLIAM	OR127	452	R12 T10 S17 SD 80	1	MIG-0223.pdf
120-008-760-1	HALL ROBERT A & KATHY S CUNNINGHA	OR204	1508	R11 T10 S17 SD 93	4.441	MIG-0399.pdf
120-008-760-0	HALL ROBERT A & KATHY S CUNNINGHA	OR204	1508	R11 T10 S17 SD 61	2.098	MIG-0399.pdf
120-004-700-0	HALLOWELL TIMOTHY & CHRIS	OR124	722	R11 T10 S17 SD 34	1.06	NoSurvey.pdf
120-004-730-0	HALLOWELL TIMOTHY & CHRIS	OR124	722	R11 T10 S17 SD 55	0.1	NoSurvey.pdf
120-004-720-0	HALLOWELL TIMOTHY & CHRIS	OR124	722	R11 T10 S17 SD 54	5.19	NoSurvey.pdf
120-004-710-0	HALLOWELL TIMOTHY & CHRIS	OR124	722	R11 T10 S17 SD 45	1.75	NoSurvey.pdf
120-000-360-0	HALLOWELL TIMOTHY A & CHRIS A	D.V 195	644	R11 T10 S17 SD 5-2	5.71	MIG-0050.pdf
120-003-590-5	HALLOWELL TIMOTHY A & CHRIS A	OR176	120	R11 T10 S17 SD 89	22.545	MIG-0360.pdf
120-003-590-6	HALLOWELL TIMOTHY A & CHRIS A	OR235	743	R11 T10 S17 SD97	5.36	MIG-0499.pdf
120-005-020-0	HANSON CLAY W & MARY P	OR227	2193	R11 T10 S17 SD 72	9.031	MIG-0092.pdf
120-003-500-1	HARDESTY RONALD GALEN & CHERI RO	OR224	3253	R11 T10 S17 SD 74	1.482	MIG-0126.pdf
120-003-490-1	HARDESTY RONALD GALEN & EDDLEBLU	OR224	3253	R11 T10 S17 SD 75	0.216	MIG-0126.pdf
120-003-910-0	HILL FRANK & DIXIE	OR209	918	R11 T10 S17 SD 15	3.31	NoSurvey.pdf
120-008-120-0	HOOK ANDY L JR & AMANDA	OR228	784	R11 T10 S17 SD 32	0.566	NoSurvey.pdf
120-008-130-0	HOOK ANDY L JR & AMANDA L	OR228	784	R11 T10 S17 SD 33	0.446	NoSurvey.pdf
120-008-110-1	HOOK ANDY L JR & AMANDA L	OR228	784	R11 T10 S17 SD 79	4.029	MIG-0210.pdf
120-008-110-0	HOOK ANDY L JR & AMANDA L	OR228	784	R11 T10 S17 SD 35	12.779	NoSurvey.pdf
120-003-590-1	HOSTETLER RYAN & MICHELLE RICHARD	OR235	1375	R11 T10 S17 SD 77	0.52	MIG-0187.pdf
120-003-590-3	HOSTETLER RYAN & MICHELLE RICHARD	OR235	1375	R11 T10 S07 SD 81	0.209	MIG-0262.pdf
120-004-630-0	KIDD CAROL A	D.V 191	724	R11 T10 S17 SD 44	5.4	NoSurvey.pdf
120-004-830-0	KIDD EDWARD W TOD-TERESA M WALTE	OR225	1523	R11 T10 S17 SD 31	0.54	MIG-0314.pdf
120-004-840-0	KIDD EDWARD W TOD-TERESA M WALTE	OR223	1523	R11 T10 S17 SD 30	0.64	MIG-0314.pdf
120-004-800-2	KIDD EDWARD W TOD-TERESA M WALTE	OR225	1523	R11 T10 S17 SD 85	8.702	MIG-0314.pdf
120-005-130-0	KUTSCHERENKO BETH ANN	OR218	2684	R11 T10 S17 SD 37	1.66	MIG-0034.pdf
120-009-020-0	LARRICK RUSSELL & SARAH BOONE	OR221	2580	R11 T10 S17 SD 68	0.75	MIG-0012.pdf
120-003-600-0	LARRICK RUSSELL & SARAH BOONE	OR221	2590	R11 T10 S17 SD 14	3.221	MIG-0426.pdf
120-005-730-1	LOCKWOOD MECHELLE AKA LOCKWOO	OR229	1337	R11 T10 S17 SD 73	1.05	MIG-0103.pdf
120-002-540-0	MCVOYT PROPERTIES LLC	OR223	2040	R11 T10 S17 SD 11	28.758	MIG-0451.pdf
120-004-430-2	MOORE SARA A	OR184	789	R11 T10 S17 SD 78	1.238	MIG-0195.pdf
120-006-810-1	MORGAN MEIGSVILLE RURAL WATER DIS	OR114	463	R11 T10 S17 SD 92	0.274	MIG-0381.pdf
120-006-810-0	MORGAN MEIGSVILLE RURAL WATER DIS	OR114	463	R11 T10 S17	1.616	NoSurvey.pdf

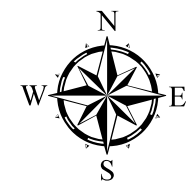

Boundaries			
	Hydro		Section
	Roads		Lot
	County		Township
	Parcel		ROW

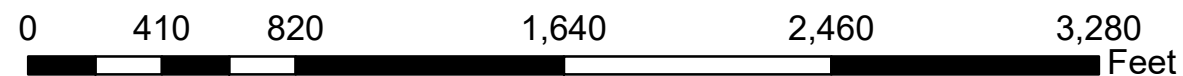

Disclaimer: The information that these maps contains is for reference purposes only. Please bring any erros to the attention of the Engineer's Office staff. Thank you

MEIGSVILLE TOWNSHIP SECTION 17 R11 TWP 10 MORGAN COUNTY, OHIO

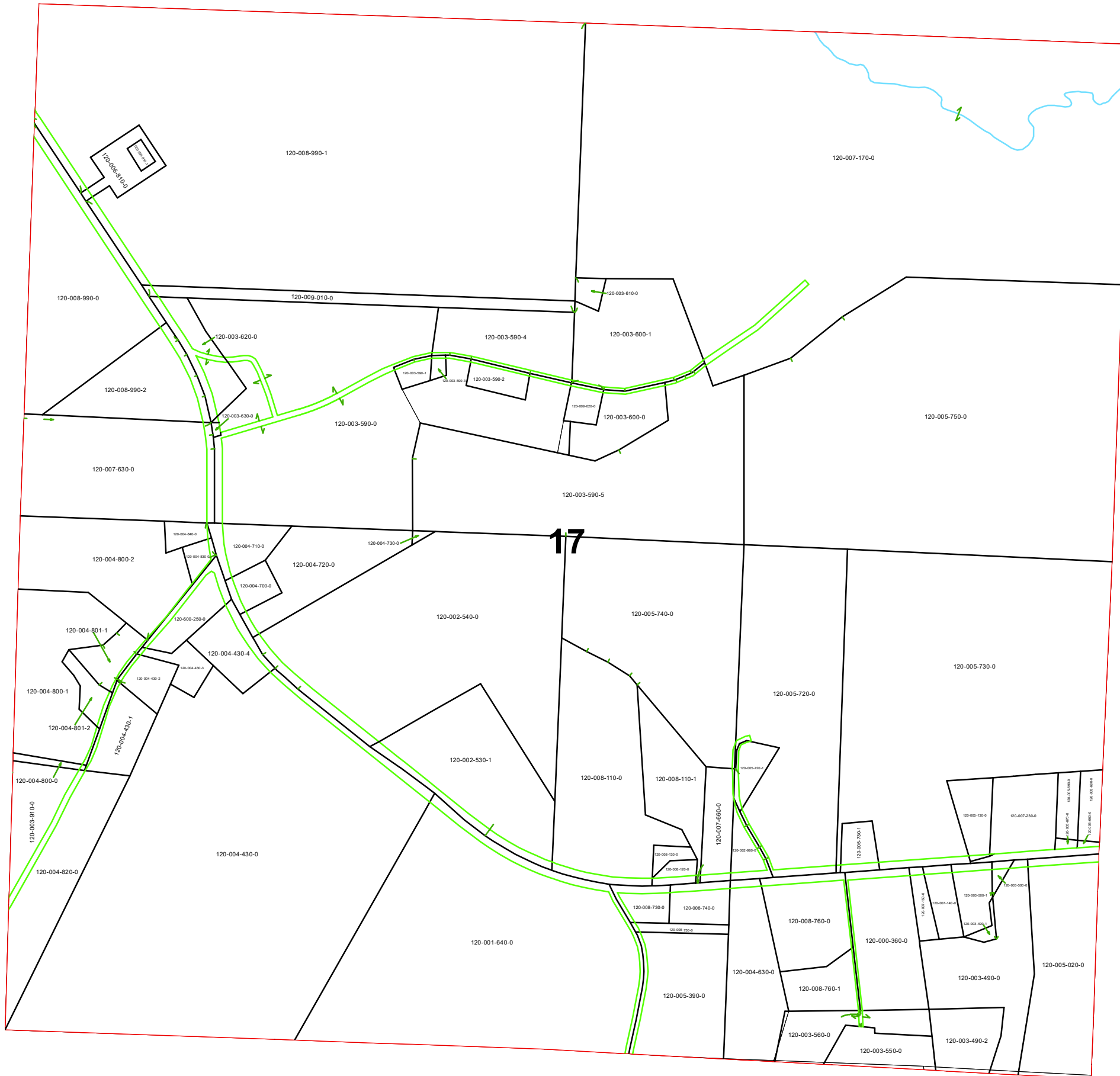

PIN	Owner	VOL	PAG	LegalDescr	Acres	Survey_Ref
120-002-980-0	MORROW JEREMY	OR232	3109	R11 T10 S17 SD 52	1.107	MIG-0280.pdf
120-005-690-0	NEWSOM KIMBERLY SUE	D.V	199 3	R11 T10 S17 SD 69	0.92	MIG-0283.pdf
120-005-680-0	NEWSOM KIMBERLY SUE	D.V	199 3	R11 T10 S17 SD 57	0.97	MIG-0283.pdf
120-005-660-0	NEWSOM KIMBERLY SUE LC-RUSSELL F	D.V	199 3	R11 T10 S17 SD 39	0.078	MIG-0410.pdf
120-005-670-0	NEWSOM KIMBERLY SUE LC-RUSSELL F	D.V	199 3	R11 T10 S17 SD 70	0.13	MIG-0283.pdf
120-004-801-2	O'BERRY JEAN	OR231	4055	R11 T1 S17 SD96	0.902	MIG-0482.pdf
120-002-530-1	OHIO POWER COMPANY	OR218	3346	R11 T10 S17 SD 94	10	MIG-0431.pdf
120-007-170-0	PEYTON SHARON ANNE ET AL	OR177	494	R11 T10 S17 SD 1 L	90.7	NoSurvey.pdf
120-004-800-1	PIERCE JANET S	OR135	438	R11 T10 S17 SD 84	7.785	MIG-0314.pdf
120-003-490-2	ROBERTS GARY D & JUDY K	OR37	167	R11 T10 S17 SD 80	2.503	MIG-0212.pdf
120-003-490-0	ROBERTS MICHAEL	OR17	135	R11 T10 S17 SD 59	7.031	MIG-0189.pdf
120-003-500-0	ROBERTS MICHAEL D	OR17	135	R11 T10 S17 SD 58	0.238	NoSurvey.pdf
120-004-430-0	SCHAAD RYAN C	OR152	212	R11 T10 S17 SD 3	60.664	MIG-0340.pdf
120-004-820-0	SCHAAD RYAN C & JESSICA D	OR231	4415	R11 T10 S17 SD 19	6.12	MIG-0137.pdf
120-004-800-0	SCHAAD RYAN C & JESSICA D	OR232	2504	R11 T10 S17 SD 18	0.239	MIG-0489.pdf
120-004-430-3	SCHAAD RYAN C & JESSICA D	OR210	76	R11 T10 S17 SD 87	1.045	MIG-0343.pdf
120-004-430-4	SCHAAD RYAN C & JESSICA D	OR210	76	R11 T10 S17 SD 90	2.267	MIG-0373.pdf
120-007-630-0	SCOBLE BRENT	OR209	883	R11 T10 S17 SD 2	11.903	MIG-0379.pdf
120-008-990-2	SCOBLE BRENT	OR209	883	R11 T10 S17 SD 91	5.332	MIG-0387.pdf
120-007-150-0	SMITH TROY B	OR54	210	R11 T10 S17 SD 60	0.76	NoSurvey.pdf
120-007-140-0	SMITH TROY B	OR54	210	R11 T10 S17 SD 42	1.18	NoSurvey.pdf
120-003-590-4	STEGNER TRAVIS & MINDY	OR101	173	R11 T10 S17 SD 83	4.86	MIG-0293.pdf
120-003-600-1	STEGNER TRAVIS & MINDY	OR101	173	R11 T10 S17 SD 82	7.19	MIG-0293.pdf
120-003-610-0	STEGNER TRAVIS & MINDY	OR101	173	R11 T10 S17 SD 17	0.48	MIG-0293.pdf
120-007-660-0	VEYON JUSTIN K	OR228	503	R11 T10 S17 SD 29	2	NoSurvey.pdf
120-008-750-0	WISE LAWRENCE A & PEGGY A	D.V	199 295	R11 T10 S17 SD 71	0.548	MIG-0080.pdf
120-008-730-0	WISE LAWRENCE A & PEGGY A	D.V	199 295	R11 T10 S17 SD 27	1.16	NoSurvey.pdf
120-008-740-0	WISE LAWRENCE A & PEGGY A	D.V	199 295	R11 T10 S17 SD 41	1.54	NoSurvey.pdf
120-005-390-0	WISE LAWRENCE A & PEGGY ANN	D.V	199 295	R11 T10 S17 SD 4 S	6.712	NoSurvey.pdf
120-003-630-0	YADON YVETTE L	OR232	5703	R11 T10 S17 SD 66	0.066	NoSurvey.pdf
120-003-620-0	YADON YVETTE L	OR232	5703	R11 T10 S17 SD 25	2.51	NoSurvey.pdf
120-003-590-0	YADON YVETTE L	OR232	5703	R11 T10 S17 SD 16	27.314	NoSurvey.pdf

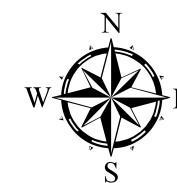

Boundaries	
	Hydro
	Section
	Roads
	Lot
	Township
	County
	Parcel
	ROW



Disclaimer: The information that these maps contains is for reference purposes only. Please bring any erros to the attention of the Engineer's Office staff. Thank you

